



E-Estate Palawan Development Corporation

Agricultural Lots / Residential Developments



Amazing views of Honda Bay

CODE: AL014

STATUS: Titled

GPS: 9.9886, 118.8355

PRICE: PHP _____

MEASURE: 43,692 Square Meters

LOCATION: Manalo, Puerto Princesa City

WEB: www.palawanproperty.com/al012.htm



View of Honda Bay on Property

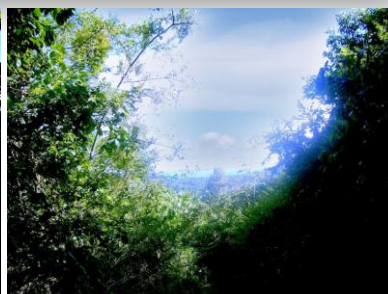

View of ocean from path



View of property interior



View of property interior



View of property interior



View of National Highway

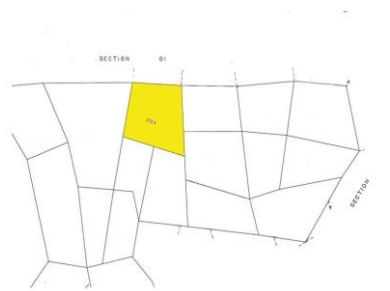

View of property tax map



View of satellite area map

OVERVIEW:

This property is extremely beautiful, not just because of its abundant fruit bearing trees, but it also have a magnificent views from the top of the property, and have clean and peaceful atmosphere, and that makes this property so ideal for vacation houses and farm development.

TRAVELING:

The property can be reach for about 45 minutes to hour travel by land from the city proper of Puerto Princesa. It is located just beside the Barangay Road and about 3 kilometers away from the national highway. The property itself can not be reached by a vehicle as of yet and must be accessed through a rugged 20 minute walk.

FACILITIES:

On the property fresh water is available from a deep well. On the property line of electricity is already available.

POTENTIALS:

The property is very ideal for productive farming and vacation houses with beautiful 365 degree views of paradise.



E-ESTATE PALAWAN

591 P.E.O. Circle, Rizal Ave. Ext., Banca Banca, Puerto Princesa City, Palawan
Tel: 48 4338501 / Fax: 48 4337792 / Mobile: +63 9209526835 / +63 9175485858
E-mail: sales@palawanproperty.com / palawanrealestate@yahoo.com